



Cosmograph Daytona

Oyster, 40 mm, white gold

**This Oyster Perpetual
Cosmograph Daytona in
18 ct white gold, with a
meteorite and black dial
and an Oysterflex
bracelet, features a
black Cerachrom bezel
with tachymetric scale.**



METEORITE DIAL

An alloy from outer space

This model is the only Cosmograph Daytona with a meteorite dial. Meteorite comes from the heart of an asteroid or possibly even a planet that has exploded, propelling material across the Solar System until chance brings it into our planet's orbit and gravity pulls it to Earth.

During its journey, the centre of the meteorite is gradually transformed, producing highly unusual metallic patterns, resulting from the very slow



THE TACHYMETRIC SCALE

High-performance chronograph

A key part of the model's identity is the bezel moulded with a tachymetric scale for measuring average speeds of up to 400 miles or kilometres per hour. Blending high technology with sleek aesthetics, the black bezel is reminiscent of the 1965 model that was fitted with a black Plexiglas bezel insert.

The monobloc Cerachrom bezel in high-tech ceramic offers a number of advantages: it is

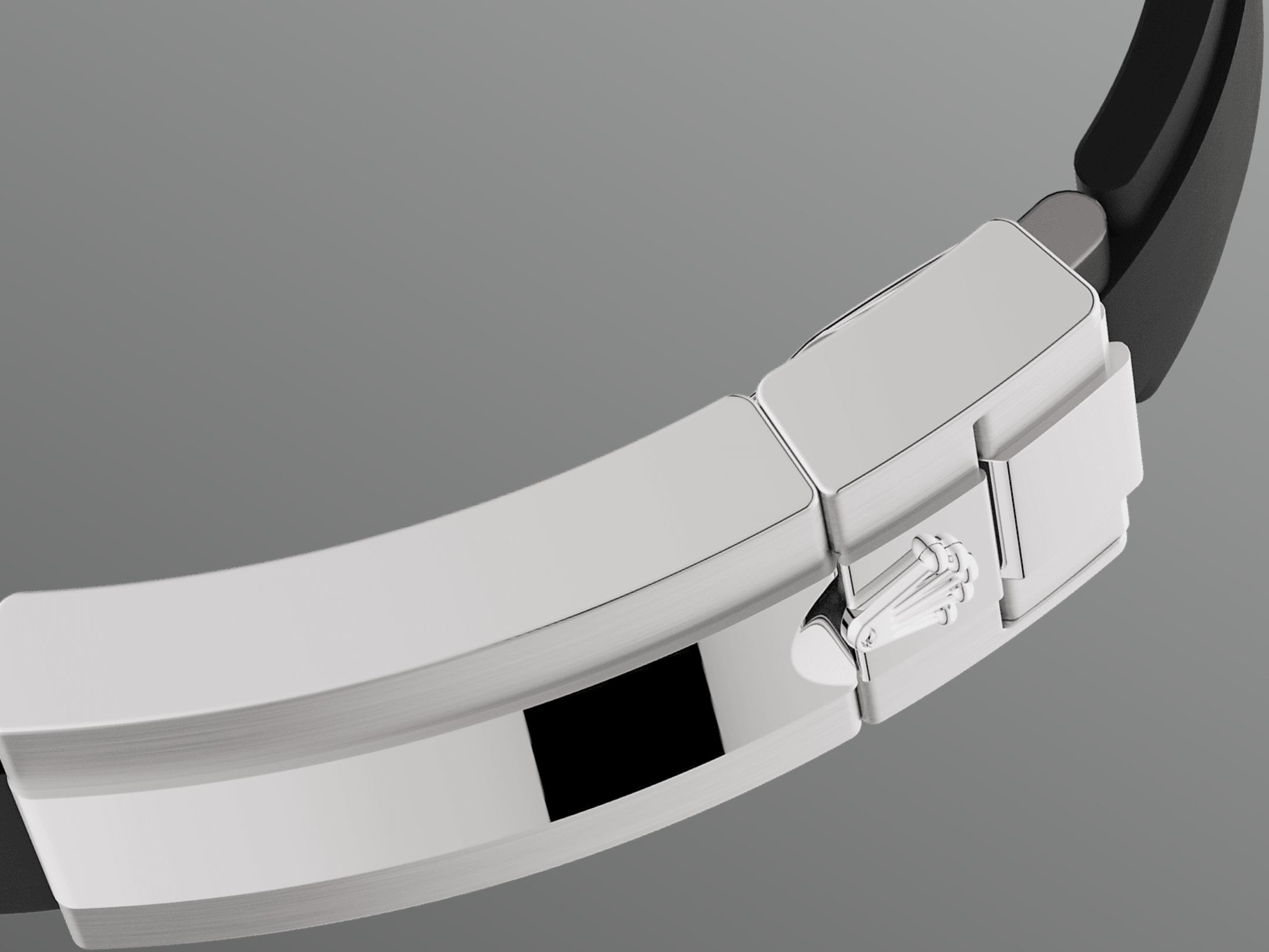

THE OYSTERFLEX BRACELET

Highly resistant and durable

The 18 ct gold versions of the Cosmograph Daytona with a Cerachrom bezel are available with an Oysterflex bracelet. Developed by Rolex and patented, it singularly combines the robustness of a metal bracelet with the comfort of an elastomer bracelet.

It is made up of two flexible curved metal blades – one in each bracelet section – overmoulded with high-performance black elastomer. For optimum

comfort, the Oysterflex bracelet is equipped with cushions on its inner sides and an Oysterlock safety clasp to prevent accidental opening. Its length may be adjusted via the ingenious Rolex Glidelock extension system.



18 CT WHITE GOLD

Commitment to excellence

By operating its own exclusive foundry, Rolex has the unrivalled ability to cast the highest quality 18 ct gold alloys. According to the proportion of silver, copper, platinum or palladium added, different types of 18 ct gold are obtained: yellow, pink or white.

They are made with only the purest metals and meticulously inspected in an in-house laboratory with state-of-the-art equipment, before the gold is

More Cosmograph Daytona technical details

Reference 126519LN

Model Case

Type

Oyster, 40 mm, white gold

Diameter

40 mm

Material

White gold

Bezel

Black monobloc Cerachrom bezel in ceramic with moulded tachymetric scale

Oyster Architecture

Monobloc middle case, screw-down case back and winding crown

Winding Crown

Screw-down, Triplock triple waterproofness system

Crystal

Scratch-resistant sapphire

Water Resistance

Waterproof to 100 metres / 330 feet

Movement

Type

Perpetual, mechanical chronograph, self-winding

Calibre

4131, manufacture Rolex

Precision

-2/+2 sec/day, after casing

Oscillator

Paramagnetic blue Parachrom hairspring. High-performance Paraflex shock absorbers

Winding

Bidirectional self-winding via
Perpetual rotor

Power reserve

Approximately 72 hours

Functions

Centre hour and minute hands,
small seconds hand at 6 o'clock.
Chronograph via centre seconds
hand, 30-minute counter at 3
o'clock and 12-hour counter at 9
o'clock. Stop seconds for exact
time setting

Bracelet

Type

Oysterflex

Clasp

Folding Oysterlock safety clasp with
Rolex Glidelock extension system

Bracelet Material

Flexible metal blades overmoulded
with high-performance elastomer

Dial

Type

Meteorite and black

Details

Highly legible Chromalight display
with long-lasting blue luminescence

Certification

Type

Superlative Chronometer (COSC +
Rolex certification after casing)

Explore and discover more on Rolex.com

All intellectual property rights such as trademarks, service marks, trade names, designs and copyrights are reserved.

Nothing contained in this website may be reproduced without written permission. Rolex reserves the right at all times to modify the models featured in the present website.

